

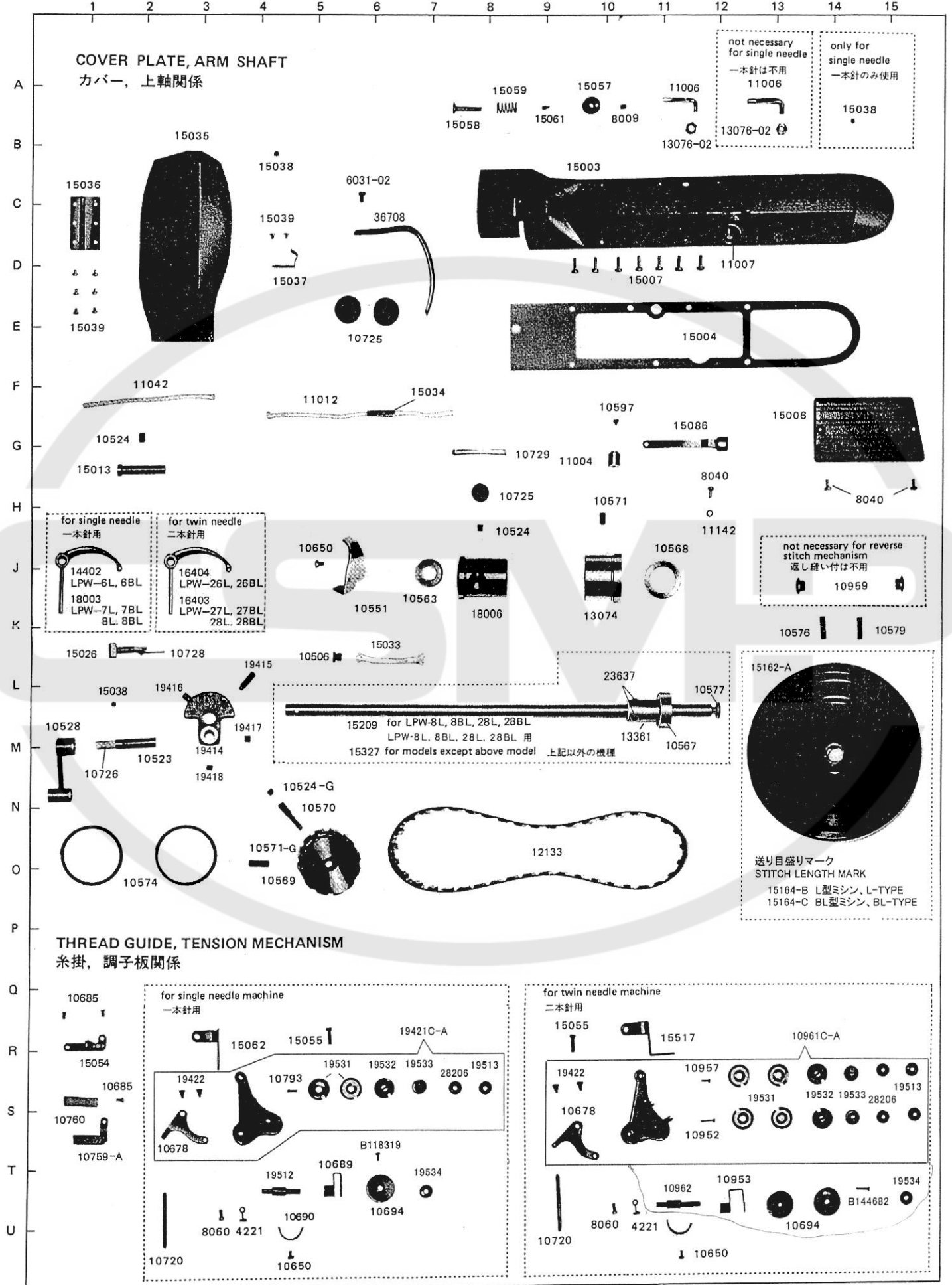

**SEIKO**  
**LPW**

**PARTS LIST**

MODEL: LPW-6L, 6BL, 7L, 7BL, 8L, 8BL (single needle, 一本針)  
LPW-26L, 26BL, 27L, 27BL, 28L, 28BL (twin needle, 二本針)



NEEDLE BAR MECHANISM FOR LPW-8L, 8BL, 28L, 28BL  
LPW-8L, 8BL, 28L, 28BL, 針棒関係

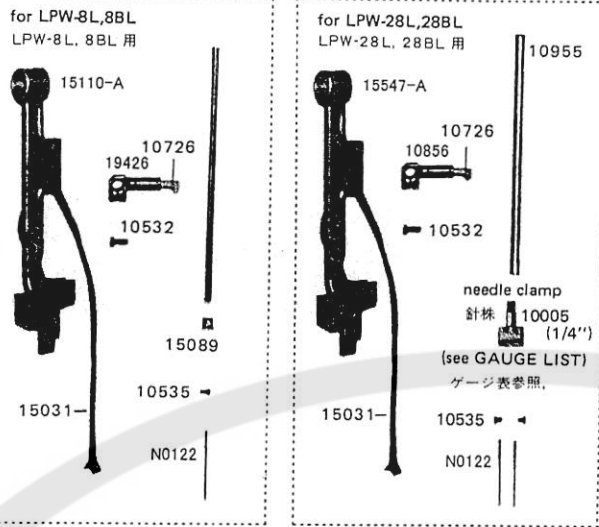

LIFTING ROCK SHAFT MECHANISM FOR LPW-8L, 8BL, 28L, 28BL  
LPW-8L, 8BL, 28L, 28BL, 横軸関係

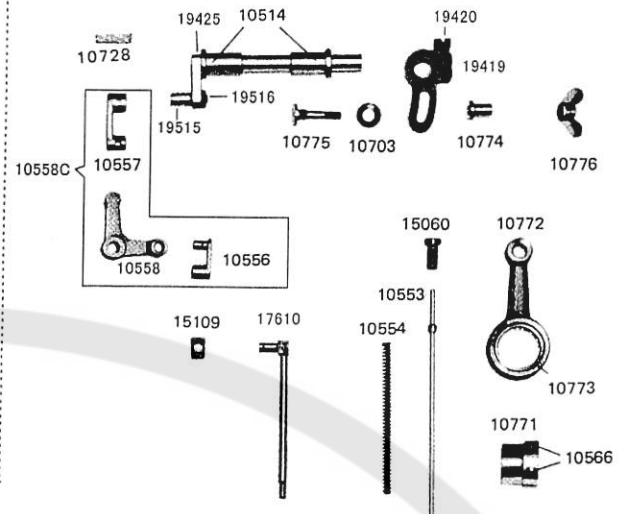

PRESSER BAR MECHANISM FOR LPW-8L, 8BL, 28L, 28BL  
LPW-8L, 8BL, 28L, 28BL, 押え棒関係

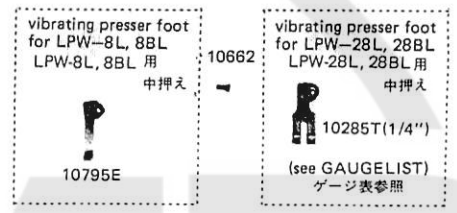
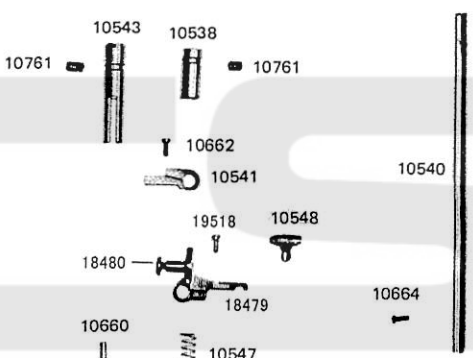

KNEE LIFTER LIFTING LEVER, CONNECTING ROD  
全機種、弓、吊り棒関係

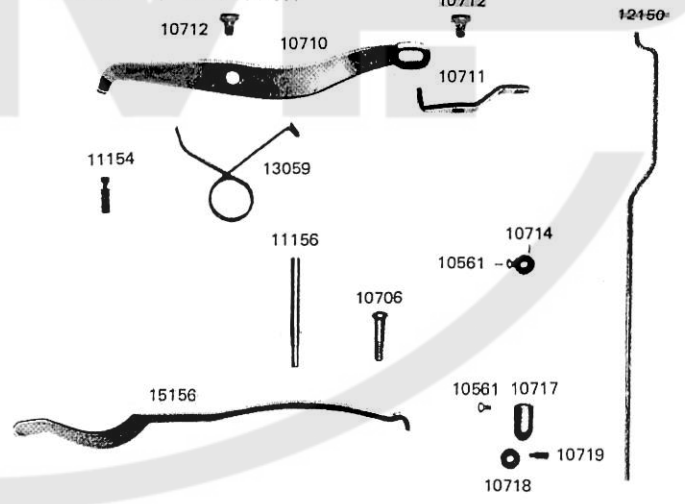

GAUGE LIST FOR LPW-28L, 28BL  
LPW-28L, 28BL ゲージ表

needle clamp 針株	lifting presser foot 外押え	vibrating presser foot 中押え	needle plate 針板	feed dog 送り歯
10002 (1/8")	10182 (1/8")	10282T (1/8")	14543 (1/8")	14563 (1/8")
10074 (5/32")	10344 (5/32")	10374T (5/32")	14544 (5/32")	14564 (5/32")
10003 (3/16")	10183 (3/16")	10283T (3/16")	14545 (3/16")	14565 (3/16")
10004 (7/32")	10184 (7/32")	10284T (7/32")	14554 (7/32")	14574 (7/32")
10005 (1/4")	10185 (1/4")	10285T (1/4")	14546 (1/4")	14566 (1/4")
10006 (5/16")	10186 (5/16")	10286T (5/16")	14547 (5/16")	14567 (5/16")
10007 (3/8")	10187 (3/8")	10287T (3/8")	14548 (3/8")	14568 (3/8")
10009 (1/2")	10189 (1/2")	10289T (1/2")	14549 (1/2")	14569 (1/2")
10011 (5/8")	10191 (5/8")	10291T (5/8")	14550 (5/8")	14570 (5/8")
10012 (3/4")	10192 (3/4")	10292T (3/4")	14551 (3/4")	14571 (3/4")

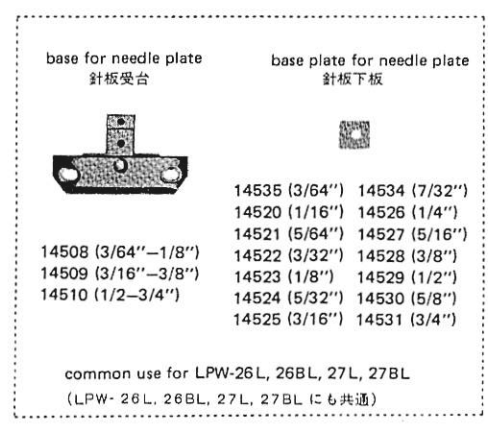

LOWER SHAFT, FEED MECHANISM

送り機構, 下軸関係

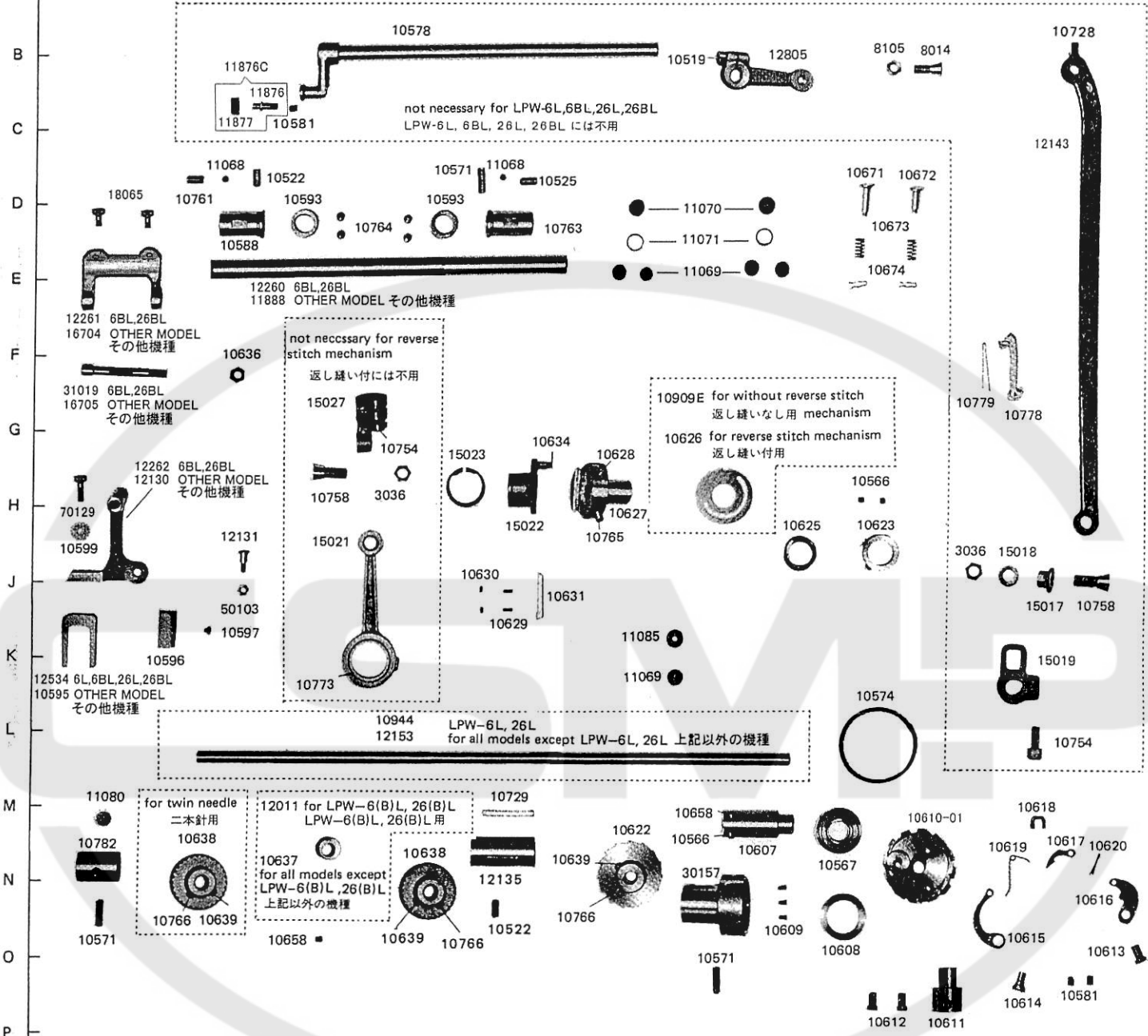

REVERSE STITCH MECHANISM

返し縫い関係

OIL WICK FOR BED

ベッド油芯関係

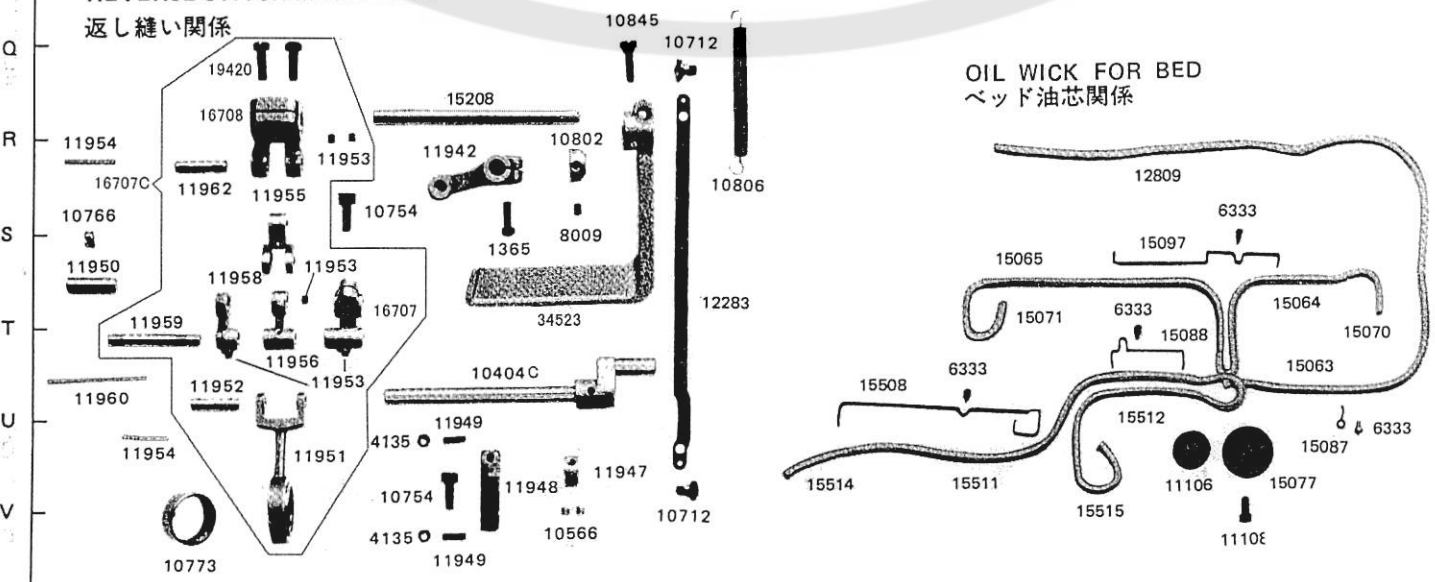





NEEDLE BAR MECHANISM FOR LPW-7L, 7BL, 27L, 27BL  
LPW-7L, 7BL, 27L, 27BL 針棒関係

NEEDLE BAR MECAHNISM FOR LPW-6L, 6BL, 26L, 26BL  
LPW-6L, 6BL, 26L, 26BL, 針棒関係

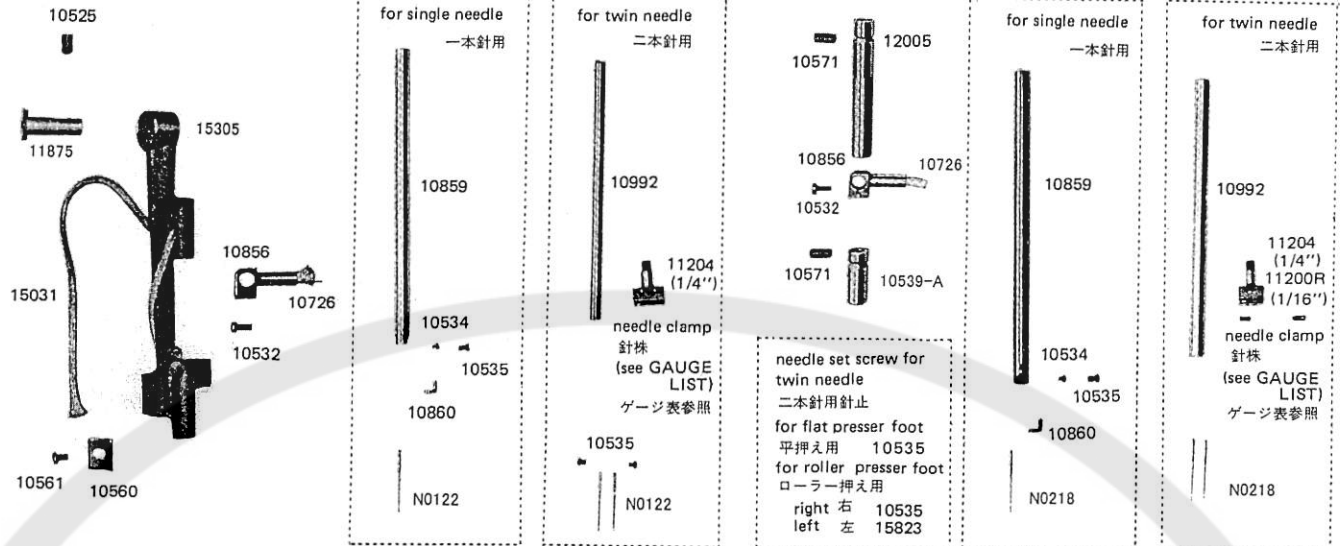

PRESSER BAR MECHANISM FOR LPW-6L, 6BL, 7L, 7BL, 26L, 26BL, 27L, 27BL  
LPW-6L, 6BL, 7L, 7BL, 26L, 26BL, 27L, 27BL 押え棒関係

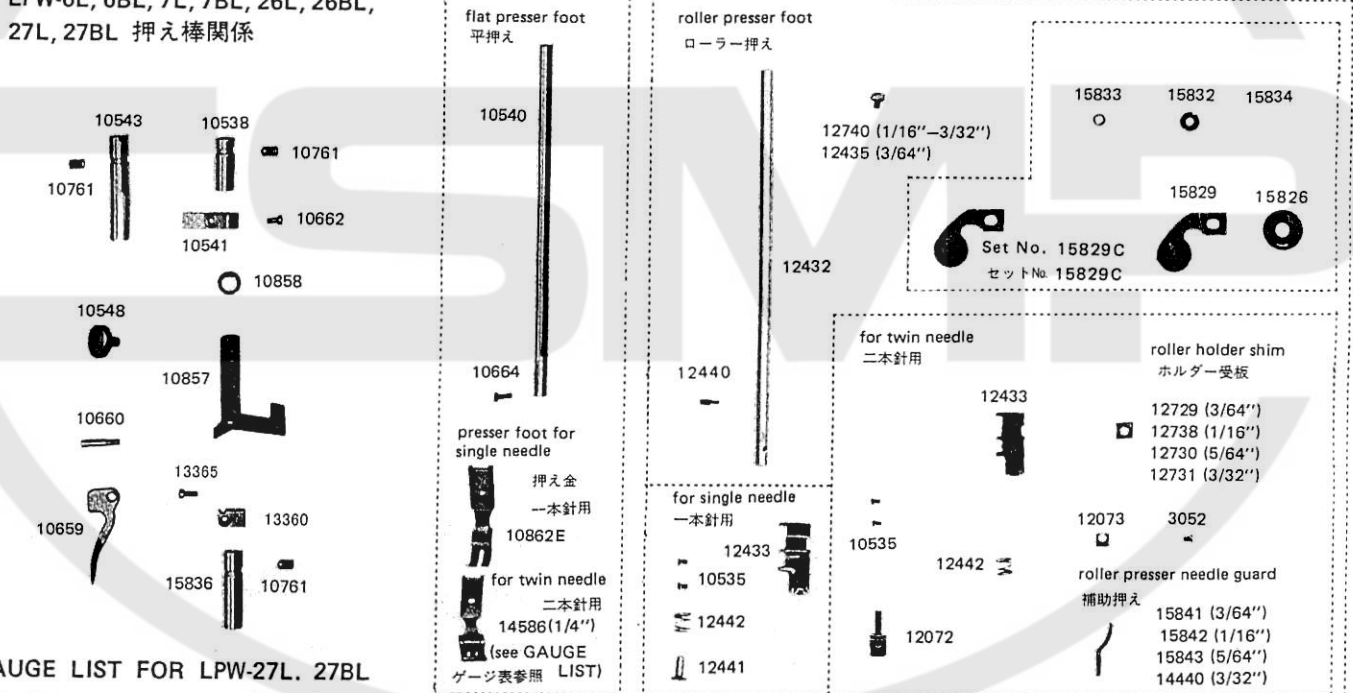

GAUGE LIST FOR LPW-27L, 27BL  
LPW-27L, 27BL, ゲージ表

GAUGE LIST FOR LPW-26L, 26BL  
(FLAT PRESSER FOOT)  
LPW-26L, 26BL, 平押え用ゲージ表

GAUGE LIST FOR LPW-26L, 26BL  
(ROLLER PRESSER FOOT)  
LPW-26L, 26BL, ローラー押え用ゲージ表

needle clamp 針株	11200 (1/16") 11199 (5/64") 14557 (3/32") 11202 (1/8") 10154 (5/32") 11203 (3/16") 10024 (7/32") 11204 (1/4") 11205 (5/16") 11206 (3/8") 10029 (1/2") 10031 (5/8") 10032 (3/4")	needle plate 針板	14540 (1/16") 14541 (5/64") 14542 (3/32") 14543 (1/8") 14544 (5/32") 14545 (3/16") 14554 (7/32") 14546 (1/4") 14547 (5/16") 14548 (3/8") 14549 (1/2") 14550 (5/8") 14551 (3/4")
presser foot 押え金	14580 (1/16") 14581 (5/64") 14582 (3/32") 14583 (1/8") 14584 (5/32") 14585 (3/16") 14594 (7/32") 14586 (1/4") 14587 (5/16") 14588 (3/8") 14589 (1/2") 14590 (5/8") 14591 (3/4")	feed dog 送り歯	14560 (1/16") 14561 (5/64") 14562 (3/32") 14563 (1/8") 14564 (5/32") 14565 (3/16") 14574 (7/32") 14566 (1/4") 14567 (5/16") 14568 (3/8") 14569 (1/2") 14570 (5/8") 14571 (3/4")

needle clamp 針株	11202 (1/8") 10154 (5/32") 11203 (3/16") 10024 (7/32") 11204 (1/4") 11205 (5/16") 11206 (3/8") 10029 (1/2") 10031 (5/8") 10032 (3/4")
-----------------	--

presser foot 押え金	14583 (1/8") 14584 (5/32") 14585 (3/16") 14594 (7/32") 14586 (1/4") 14587 (5/16") 14588 (3/8") 14589 (1/2") 14590 (5/8") 14591 (3/4")
------------------	--

needle plate 針板	14463 (1/8") 14464 (5/32") 14465 (3/16") 14474 (7/32") 14466 (1/4") 14467 (5/16") 14468 (3/8") 14469 (1/2") 14470 (5/8") 14471 (3/4")
-----------------	--

feed dog 送り歯	14483 (1/8") 14484 (5/32") 14485 (3/16") 14494 (7/32") 14486 (1/4") 14487 (5/16") 14488 (3/8") 14489 (1/2") 14490 (5/8") 14491 (3/4")
--------------	--

needle clamp 針株	11198R (3/64") 11200R (1/16") 11199R (5/64") 11201R (3/32")
needle plate 針板	14433 (3/64") 14434 (1/16") 14438 (5/64") 14437 (3/32")
feed dog 送り歯	14443 (3/64") 14444 (1/16") 14445 (5/64") 14446 (3/32")

