

1. MACHINE FRAME & TENSION PARTS COMPONENTS

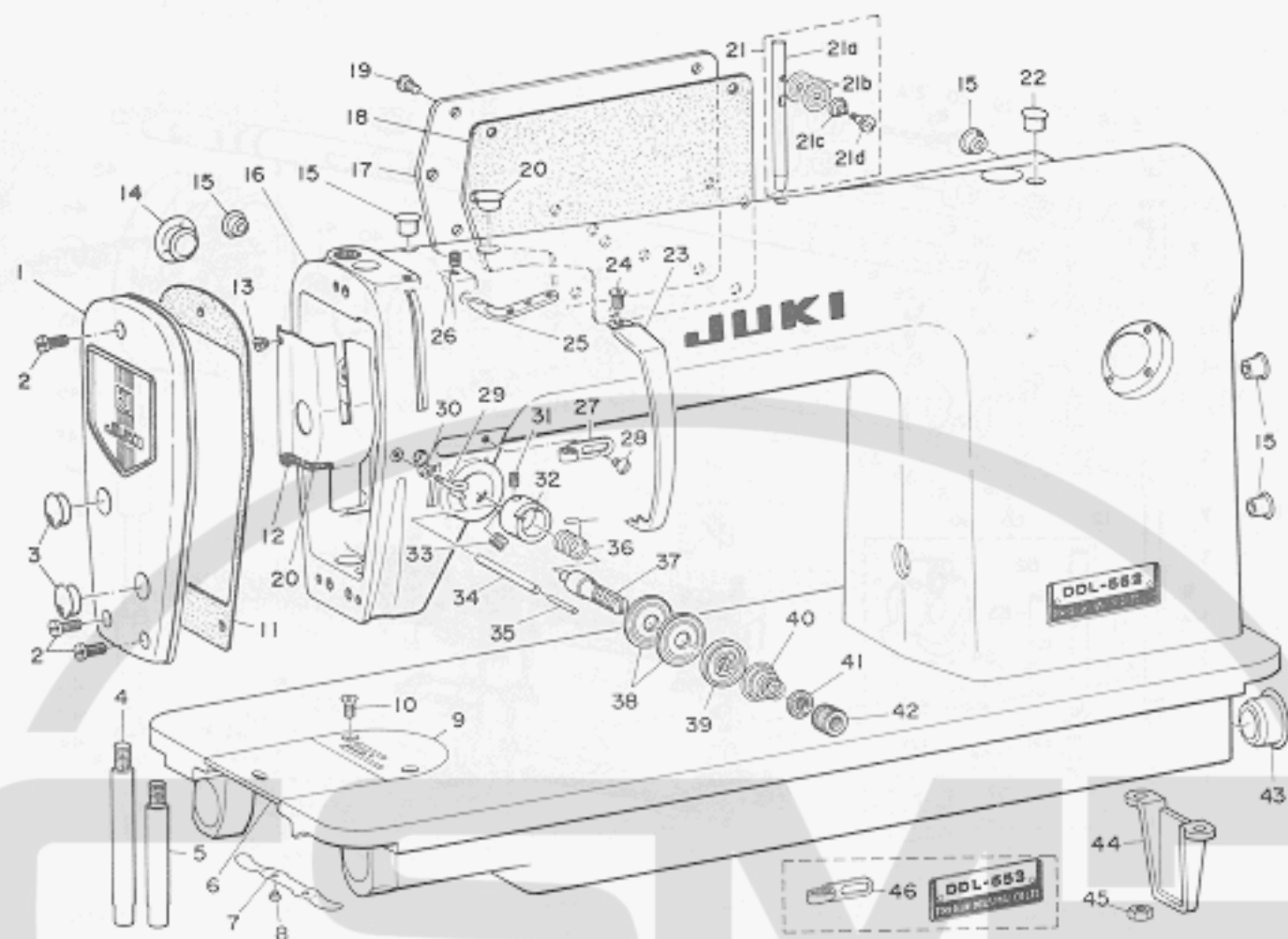

Ref. No.	Part No.	Description	Amt. Req.	Ref. No.	Part No.	Description	Amt. Req.
1	B-1121-552-0A0	Face plate	1	23	B-1123-552-000A	Thread take-up lever oil guard	1
2	SS-7111120-SP	. . . Screw	3	24	SS-7110510-SP	. . . Screw	1
3	B-1179-552-000	. . . Rubber plug	2	25	B-1128-522-000	Three-hole thread eyelet	1
4	B-1104-122-000	Bed screw stud (A)	1	26	SS-8110910-SP	. . . Screw	1
5	B-1105-122-000	Bed screw stud (B)	1	27	B-1126-552-000	Frame thread guide (A) (DDL-552,5)	1
*6	B-1110-012-0A0	Bed slide, assembly	1	28	SS-5090610-SP	. . . Screw	1
7	B-1111-012-000	Bed slide spring	①	29	B-3114-761-000	Frame thread guide (B)	1
8	SS-6060210-SP	. . . Screw	②	30	NS-6060350-SP	. . . Set nut	1
9	B-1109-552-000	Throat plate, for DDL-552	1	*B-3111-552-0A0	Tension post, assembly (Ref. No. 31, 32, 36~42)	1	
(9)	B-1109-543-000	Throat plate, for DDL-553	(1)	31	SS-8090670-SP	Screw	①
10	SS-2110920-TP	. . . Screw	2	32	B-3111-552-800	Tension post socket	①
11	B-1122-552-000	Face plate gasket	1	36	B-3128-012-000	Take-up spring	①
12	B-1188-552-000	Arm oil shield	1	37	B-3115-552-000	Tension post	①
20	CO-2020000-00	. . . Oil wick	1	38	B-3126-012-000	Tension disc	②
13	SS-6080410-SP	. . . Screw	1	39	B-3132-552-000	Tension release washer	①
(13)	SS-6080320-SP	. . . Screw, for DDL-553	(1)	40	B-3129-012-A00	Tension spring	①
14	B-1164-012-000	Rubber plug, large	1	41	B-3120-125-000	Tension disc stop	①
15	B-1117-552-000	Rubber plug	5	42	B-3116-125-000	Tension nut	①
16	B-1101-552-0A0	Machine frame & bed, assembly for DDL-552, 3	1	33	SS-8150710-SP	Clamp screw, for socket	1
(16)	B-1101-555-0A0	Machine frame & bed, assembly for DDL-555	(1)	34	B-3127-127-000	Tension release auxiliary pin	1
17	B-1118-522-000	Side plate	1	35	B-3118-552-000	Tension release pin	1
18	B-1119-522-000	. . . Gasket	1	43	B-1166-552-000A	Bed shaft rubber plug	2
19	SS-7110910-SP	. . . Screw	8	44	B-1105-122-000	Bed leg	1
*21	B-1113-155-0A0	Needle thread guide pin, assembly	1	45	NS-6150310-SP	. . . Nut	2
21a	B-1113-155-000	Needle thread guide pin	①	46	B-1126-553-000	Frame thread guide (A), for DDL-553	1
21b	B-3148-123-000	. . . Tension disc	②				
21c	B-3149-123-A00	. . . Tension spring	①				
21d	SD-0380552-SL	. . . Hinge screw	①				
22	B-1186-552-000	. . . Rubber plug	2				

ARTS Import Error:

Application error: LZW minimum code size other than 8 bit not supported in GIF file 'E:\www\images\PartsBook\juki\DDL-552\0002.gif'



3. PRESSER BAR, LIFTING LEVER & HOOK DRIVING SHAFT COMPONENTS

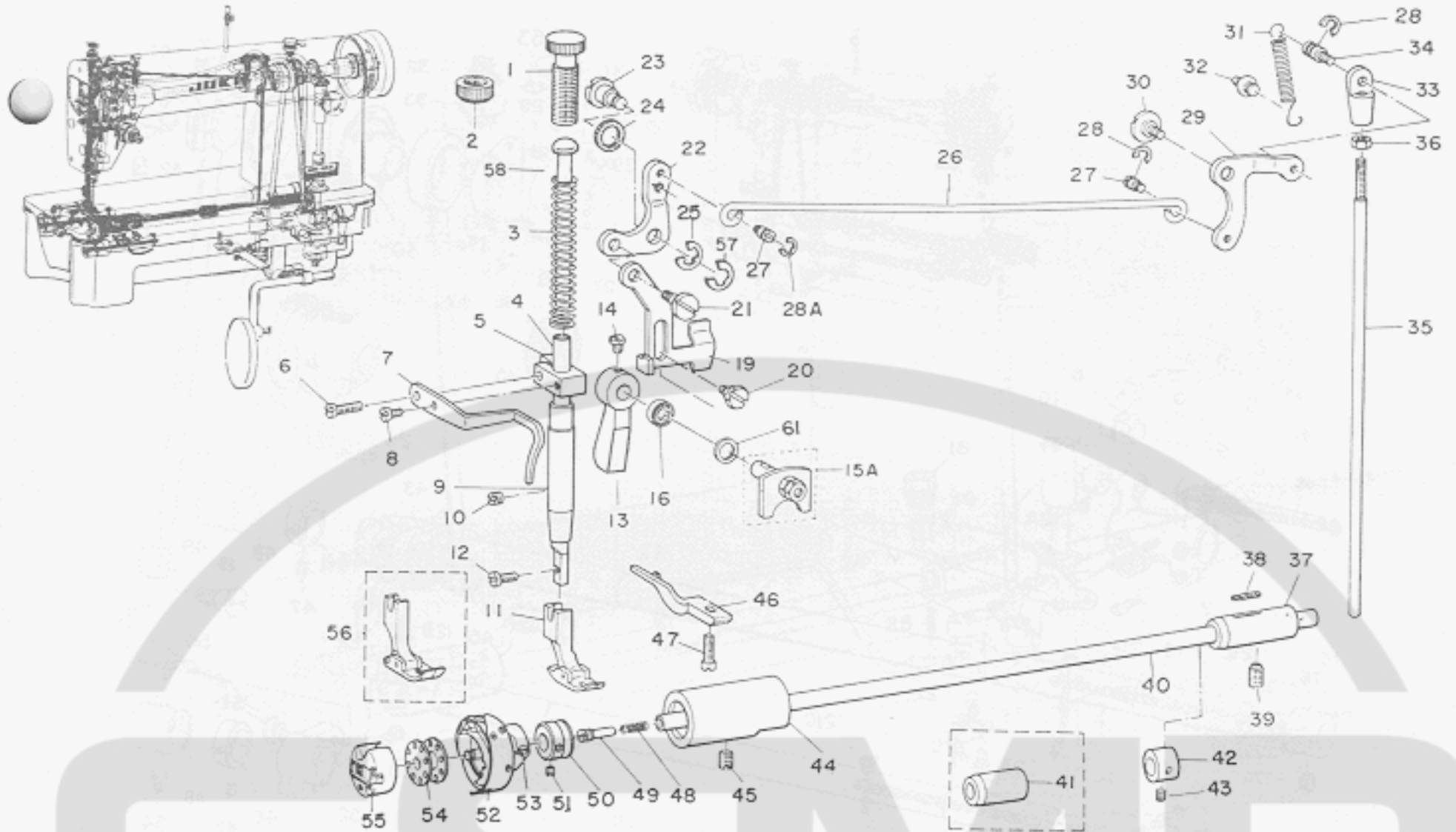

Ref. No.	Part No.	Description	Amt. Req.	Ref. No.	Part No.	Description	Amt. Req.
1	B-1509-227-000	Presser spring regulator	1	29	B-3414-552-000	Lifting lever link, right	1
58	B-1510-227-000	Presser guide bar	1	30	SD-0720331-SP	... Hinge screw	1
2	NS-2820850-SA	... Nut	1	31	B-3417-552-000	... Spring	1
3	B-1505-227-000A	Presser spring	1	32	B-3413-227-000	... Suspension screw	1
(3)	B-1505-552-000A	Presser spring (DDL-553)	(1)	33	B-3416-012-000	Swivel	1
4	B-1501-127-000	Presser bar	1	34	B-3418-552-000	... Screw	1
5	B-1507-552-000	Presser bar guide bracket	1	35	B-3415-552-000	Lifting lever connecting rod, vertical	1
6	SS-7111410-SP	... Clamp screw	1	36	NS-6620310-SP	... Nut	1
7	B-1521-552-000	Slack thread regulator	1	37	B-1804-552-800	Hook driving shaft bushing rear	1
8	SS-6090650-SP	... Screw	1	38	B-1806-038-000	... Oil felt	1
9	B-1502-541-000	Presser bar bushing, lower	1	39	SS-8151550-SP	... Screw	1
10	SS-8150310-SP	... Screw	1	40	B-1801-412-000	Hook driving shaft	1
11	B-1524-012-0A0	Presser foot assembly, for DDL-555	1	41	B-1803-552-000	... Bushing, intermediate	1
(11)	B-1524-552-0A0	Presser foot assembly, for DDL-552	(1)	44	B-1802-412-0A0	... Bushing, front(assembly)	1
56	B-1511-543-8A0	Presser foot assembly, for DDL-553	(1)	45	SS-8151150-SP	... Screw	1
12	SS-7091110-SP	... Screw	1	46	B-1835-012-000	Bobbin case holder positioning finger	1
13	B-1520-552-000	Hand lifter	1	47	SS-6111010-SP	... Screw	1
14	SS-7120910-SP	... Screw	1	49	B-1808-552-0A0	Oil seal screw	1
*15A	B-1518-552-0A0	Hand lifter cam, assembly	1	48	B-1810-552-000	Oil wick	(1)
61	WP-0740516-SP	Washer, for hand lifter hinge pin	1	50	CS-0791066-SH	Hook driving shaft thrust collar	1
16	B-1522-552-000	... Oil seal ring	1	51	SS-8110410-TP	... Screw	2
19	B-1515-552-000	Lifting lever	1	*52	B-1830-127-0A0	Hook, assembly	1
20	SD-0630275-SP	... Hinge screw (A)	1	53	SS-6110560-TP	... Screw	(2)
21	SD-0630301-SP	... Hinge screw (B)	1	54	B-9117-012-000	Bobbin	1
22	B-1516-552-000	... Link, left	1	55	B-1837-012-0A0	Bobbin case, assembly	1
23	B-1517-552-000	... Hinge pin	1	42	CS-0791016-SH	Thrust collar (B)	1
24	B-3431-581-000	... Gasket	1	43	SS-8110520-TP	... Screw	2
25	RE-0600000-K0	... Snap ring	1				
57	B-1523-226-000	... Snap ring (B)	1				
26	B-3412-552-000	Lifting lever connecting rod	1				
27	B-3416-552-000	... Hinge screw	1				
28	RE-0500000-K0	... Snap ring	3				

4. FEED ROCKER SHAFT & FEED DRIVING SHAFT COMPONENTS

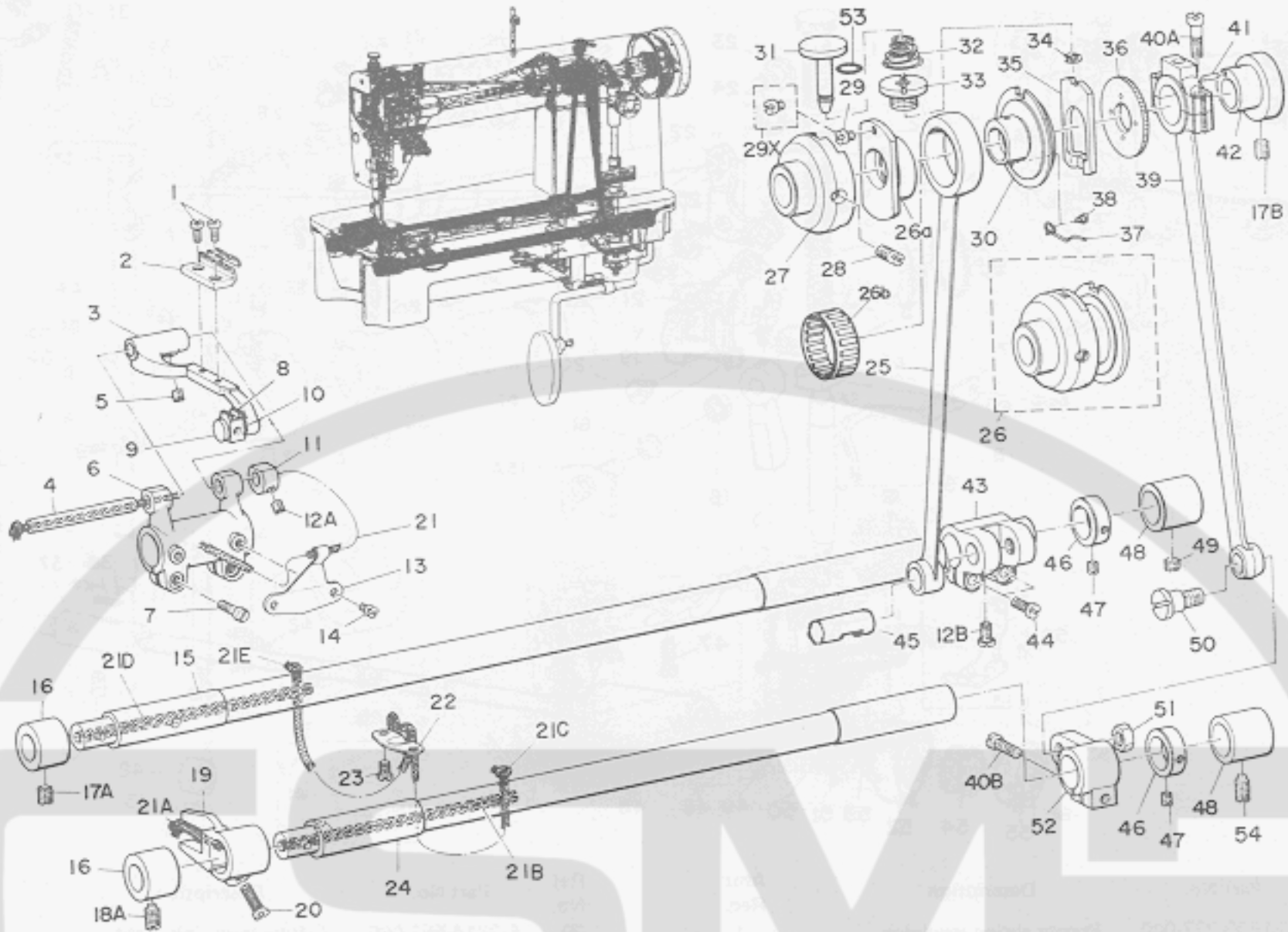

Ref. No.	Part No.	Description	Amt. Req.	Ref. No.	Part No.	Description	Amt. Req.
1	SS-4080620-TP	Screw	2	26a	B1610-552-000-A	Feed eccentric	①
2	B1613-552-000	Feed dog, for DDL-552	1	26b	B1426-352-B00	Needle bearing	①
(2)	B1613-543-000	Feed dog, for DDL-553	(1)	29	B1615-552-000	Positioning screw	①
*3	B1602-155-080	Feed bar	1	29x	B1615-553-000	Positioning screw, for DDL-553	(1)
5	SS-8620610-TP	Clamp screw	①	30	B1612-552-000-A	Stitch regulator	①
4	B1604-012-000	Feed bar shaft	1	31	B1618-552-0A0-A	Thumb screw stud, assembly	1
6	B1603-155-000	Feed locker	1	32	B3118-352-000	Spring	1
7	SS-7111310-TP	Clamp screw	2	33	B1621-552-000	Guide	1
11	CS-0640863-SH	Thrust collar	1	34	RE-0500000-KE	Snap ring	1
12A	SS-8110510-SP	Screw	2	35	B1623-552-000	Ratchet pawl	1
13	B1609-155-000	Oil wick holder	1	36	B1619-155-000	Ratchet gear	1
14	SS-6080410-SP	Screw	2	37	B1624-552-000	Ratchet pawl spring	1
15	B1601-552-000	Feed rocker shaft	1	38	SD-0260271-SP	Screw	1
16	B1604-155-000	Bushing, front	2	39	B1708-555-000	Connecting rod	1
17A	SS-8150710-SP	Screw	1	40A	SS-6121610-SP	Screw	2
18A	SS-8151550-SP	Screw	1	42	B1709-552-000	Feed driving eccentric	1
19	B1704-155-000	Feed driving shaft crank, front	1	17B	SS-8150710-SP	Screw	2
20	SS-7111120-SP	Clamp screw	1	41	B1620-155-000	Ratchet pawl connecting pin	1
21	CQ-2020000-00	Oil wick	1	*43	B1607-155-0A0-A	Feed rocker shaft crank	1
21A	CQ-2020000-00	Oil wick	1	44	SS-7121410-SP	Clamp screw	2
21B	CQ-3030000-00	Oil wick	1	12B	SS-7110710-SP	Screw	1
21C	CQ-3030000-00	Oil wick	1	45	B1611-155-000-A	Hinge screw	1
21D	CQ-3030000-00	Oil wick	1	46	CS-1471212-SH	Thrust collar	2
21E	CQ-3030000-00	Oil wick	1	47	SS-8660610-TP	Screw	4
22	B1635-552-000	Oil wick holder	1	48	B1702-155-000	Bushing, rear	2
23	SS-7110540-SP	Screw	2	49	SS-8150410-SP	Screw	1
24	B1702-552-000	Feed driving shaft	1	18B	SS-8150710-SP	Screw	1
25	B1609-552-000	Feed rocker shaft connecting rod	1	50	SD-1020701-SP	Hinge screw	1
*26	B1610-552-0A0-A	Feed eccentric, complete (DDL-552)	1	51	NS-6680410-SP	Nut	1
(26)	B1610-553-0A0-A	Feed eccentric, complete (DDL-553)	1	52	B1703-155-000	Feed driving shaft crank, rear	1
27	B1611-552-000-A	Feed eccentric body	①	40B	SS-6121610-TP	Clamp screw	1
28	SS-8661430-SP	Screw	②	53	RO-0611801-00	Rubber ring	1

5. OIL LUBRICATION MECHANISM COMPONENTS

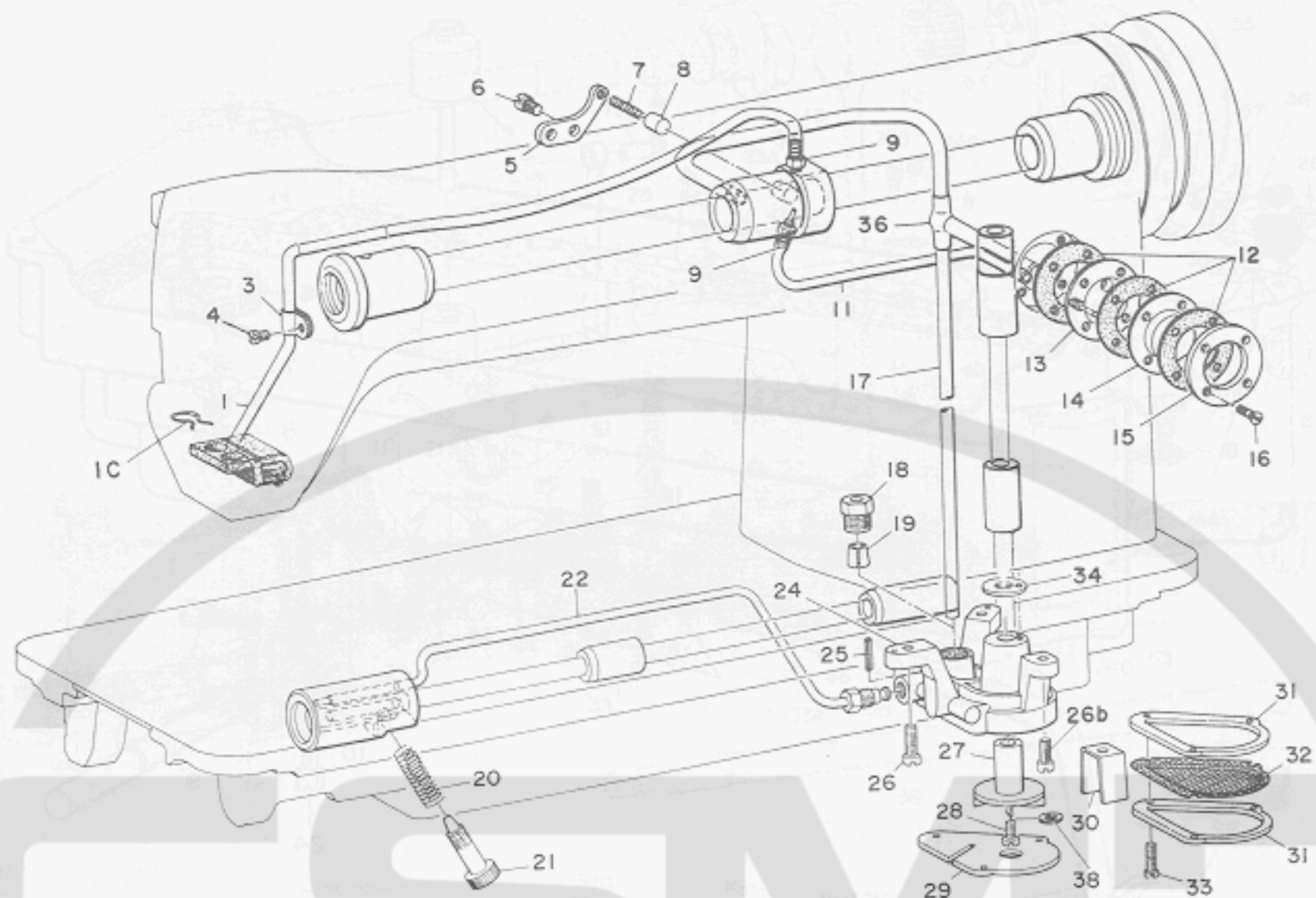

Ref. No.	Part No.	Description	Amt. Req.	Ref. No.	Part No.	Description	Amt. Req.
1	B-3528-552-0A0	Oil sponge assembly	1	21	B-3514-412-000	Oil adjusting screw	1
1C	B-3529-226-000	. . . Presser	1	22	B-3521-552-0A0	Hook driving shaft oil tube, assembly	1
3	B-3536-122-000	Oil return tube holder	1	24	B-3501-552-0A0	Lubricating oil pump (with pin)	1
4	SS-7110710-SP	. . . Screw	1	25	PS-0200122-K0	. . . Spring pin	2
5	B-3524-552-000	Plunger thrust plate	1	26	SS-7121410-SP	. . . Screw	3
6	SS-7110910-SP	. . . Screw	2	(26)	SS-7121410-SP	Screw (A), for DDL-555	2
7	B-1214-038-000	. . . Spring	1	(26b)	SS-6121210-SP	Screw (B), for DDL-555	1
8	B-3534-155-000	Lubrication pump plunger	1	27	B-3507-155-000	. . . Impeller	1
9	SQ-1110402-MZ	Oil tube connecting screw	2	28	SS-6081010-TP Screw	1
11	BP-3000000-00	Oil sight window oil tube	1	38	WP-0550800-SP	. . . Washer	1
12	B-3516-552-000	Oil sight window gasket	3	29	B-3502-122-000	Cover	1
13	B-3531-552-000	Oil sight window base	1	30	B-3545-122-000	. . . Oil guard	1
14	B-3513-352-000	Oil sight window	1	31	B-3503-122-000	. . . Frame	2
15	B-3514-552-000	Oil sight window frame	1	32	B-3504-155-000	. . . Filter screen	1
16	SS-2091520-SP	. . . Screw	4	33	SS-6081210-SP	. . . Screw, for cover	3
17	B-3513-227-000	Main shaft oil pipe	1	34	B-3510-552-000	Thrust collar rotation stopper plate	1
18	B-3512-122-000	. . . Clamp sleeve nut	1	36	B-3527-552-000	Lubrication pipe rubber joint	1
19	B-3511-122-000	. . . Clamp sleeve nut	1				
20	B-2616-372-000	Spring	1				

6. OIL RESERVOIR & KNEE LIFTER COMPONENTS

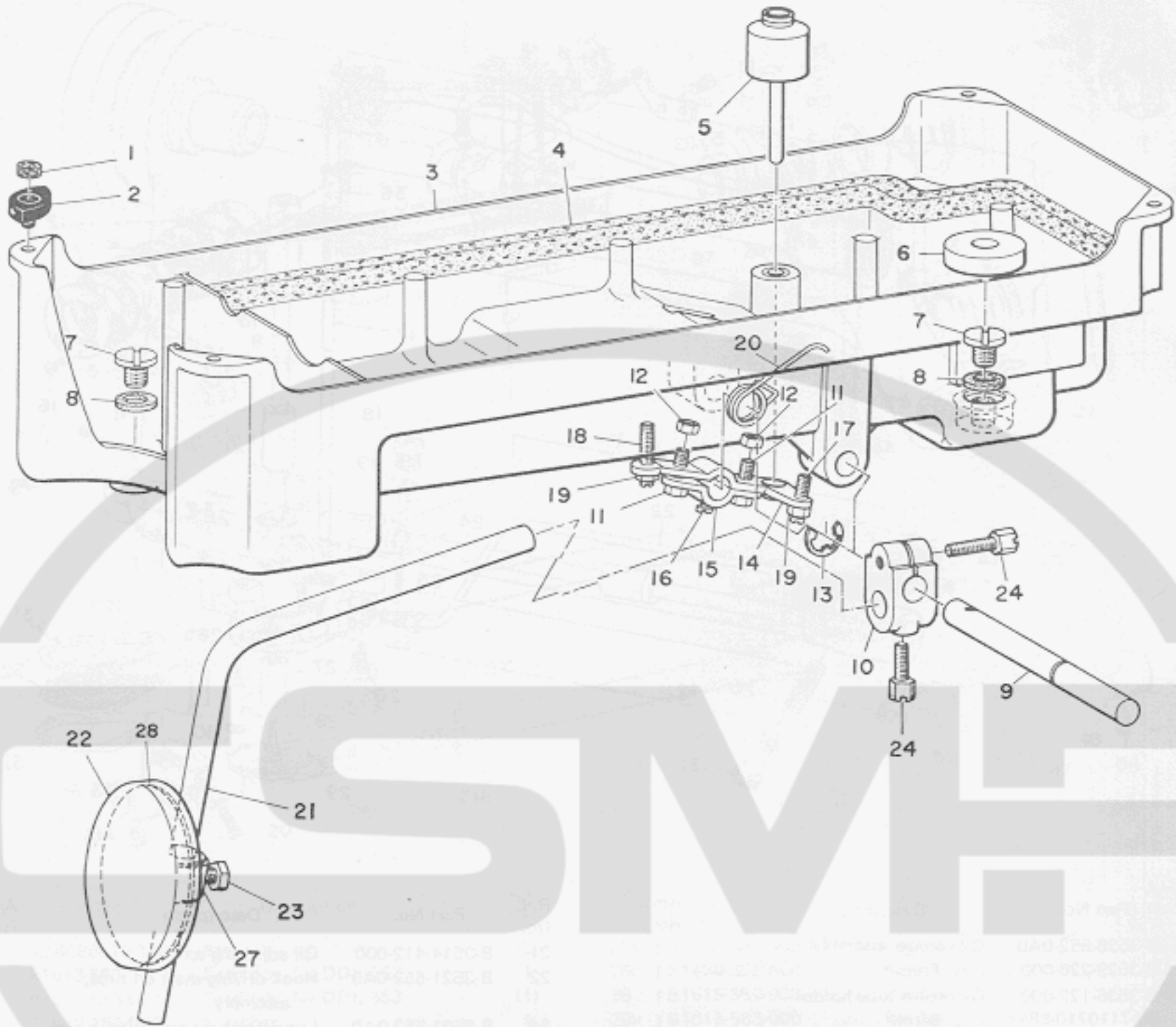

Ref. No.	Part No.	Description	Amt. Req.	Ref. No.	Part No.	Description	Amt. Req.
*	B8217-552-0C0	Oil reservoir complete (Ref. No.1~20,24)	1	13	B-3426-552-000	Thrust ring	①
*	B8217-552-0A0	Oil reservoir assembly (Ref. No.1~4,7,8)	1	14	B-3425-552-000	Lifter lever (B)	①
1	B-8227-125-000	Felt pad	4	15	B-3424-552-000	Lifting lever (A)	①
2	B-8226-125-000	Rubber pad	4	16	SS-9151120-SR	Screw	①
5	B-3421-552-0A0	Knee press lifter rod, assembly	1	17	SS-8152080-SR	Positioning screw (B)	①
6	B-8228-125-000	Oil reservoir magnet	1	18	SS-8153010-SR	Positioning screw (A)	①
3	B-8217-552-000	Oil reservoir	①	19	NS-6150430-SR	Nut	②
4	B-8218-552-000	Gasket	①	20	B-3429-552-000	Spring	①
7	SS-6741010-SP	Oil drain cap screw	②	24	SS-9182010-SN	Clamp screw, for No. 10	②
8	B-8219-125-000	Gasket	②	*B-3419-552-0A0	Knee lifter plate rod complete (No. 21~ 23, 27, 28)	①	
	*B-3420-552-0A0	Knee press rod complete (Ref. No. 9~ 20, 24)	①	21	B-3419-122-000	Knee lifter plate rod	①
9	B-3420-552-000	Knee press rod	①	22	B-3431-552-000	Knee press plate cover	①
10	B-3427-122-000	Bearing bracket	①	23	SM-9061003-SE	Screw, for knee press plate stopper	①
11	SS-9151540-SR	Clamp screw	②	27	B-3432-552-000	Knee press plate stopper	①
12	NS-6150430-SR	Nut	②	28	B-3430-552-000	Knee press plate	①

7. EXCLUSIVE PARTS FOR DDL-555

NUMERICAL INDEX OF PARTS

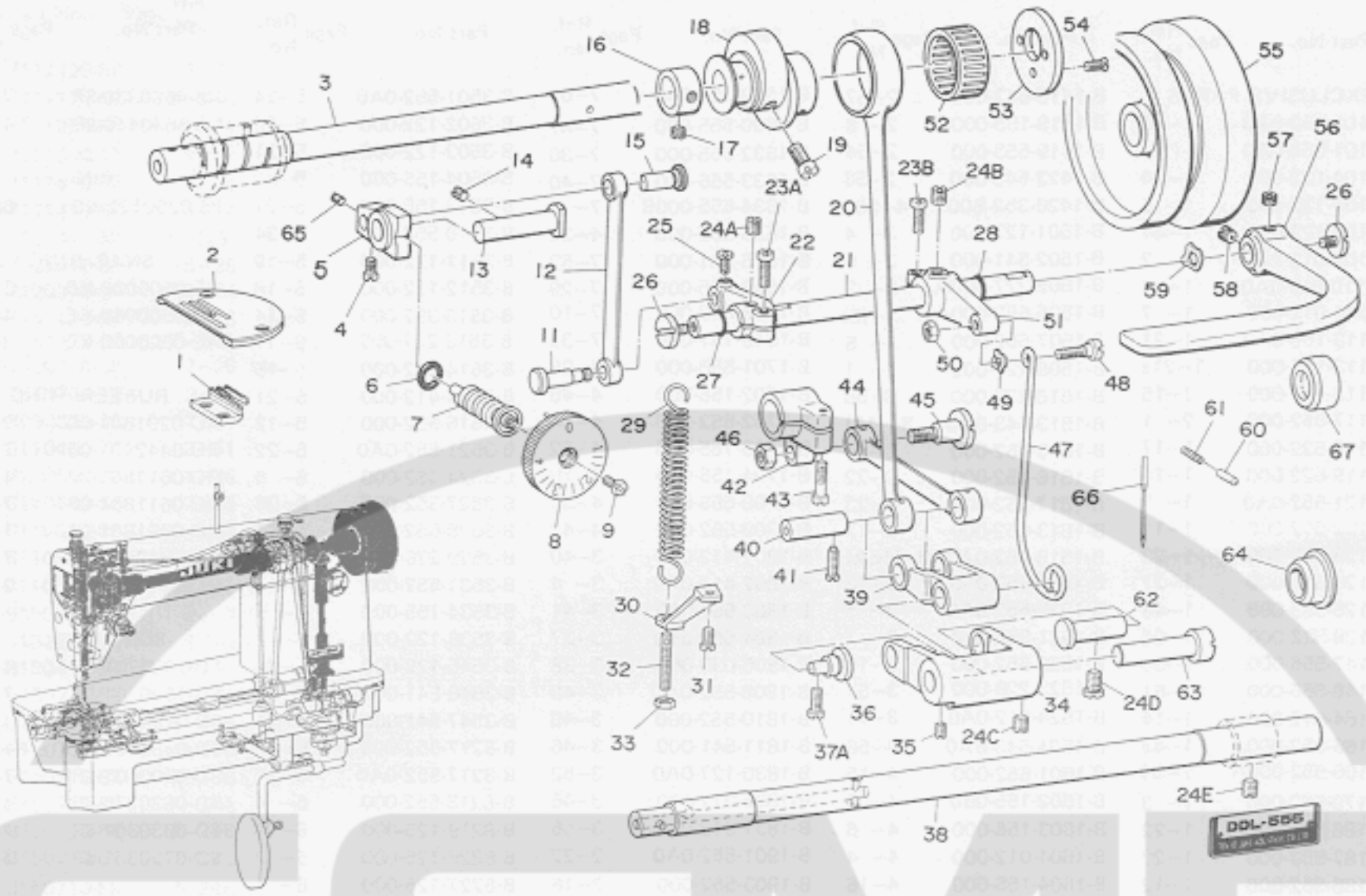

Ref. No.	Part No.	Description	Amt. Req.	Ref. No.	Part No.	Description	Amt. Req.
1	B-1613-012-A00	Feed dog (A)	1	35	SS-8620610-SP	Screw (B)	1
2	B-1109-012-A00	Throat plate (A)	1	36	B-1619-555-000	Hinge pin	1
3	B-1201-555-000	Main shaft	1	37A	SS-7111120-SP	Screw	1
5	B-1620-161-000	Feed regulator	1	38	B-1701-555-000	Feed driving shaft	1
4	SS-7110720-SP	Screw (A)	1	39	B-1614-555-000	Feed driving rocker arm	1
65	SS-8110510-SP	Screw (B)	1	40	B-1633-555-000	Connecting pin	1
6	RO-0742401-00	Rubber ring	1	41	SS-7111260-SP	Screw	1
7	B-1634-555-000B	Stitch length regulating screw	1	42	B-1608-161-000	Feed rocker shaft crank, rear	1
8	B-1623-555-0A0A	Feed regulator dial, assembly	1	43	SS-6121610-TP	Clamp screw	1
10	B-1648-012-000	Stop pin	1	44	B-1613-555-000	Connecting rod	1
9	SS-6121050-SP	Screw	1	45	SD-1020701-SP	Hinge screw	1
11	B-1628-555-000	Tension spring suspension stud	1	46	NS-6680330-SP	Nut	1
12	B-1625-555-000	Feed regulator connecting rod	1	47	B-1630-555-000	Feed driving rocker arm connecting rod	1
13	B-1622-555-000	Feed regulator hinge pin	1	48	SD-0500401-SP	Hinge screw	1
14	SS-8151230-SP	Screw	1	49	WZ-0541510-KP	Washer	1
15	B-1626-555-000	Feed regulator connecting rod pin	1	50	NS-6120310-SP	Nut	1
16	CS-1471212-SH	Thrust collar	1	51	B-1629-555-000	Control lever crank, rear	1
17	SS-8660610-TP	Screw	2	24B	SS-8150710-SP	Screw	1
18	B-1610-555-0A0	Feed eccentric	1	23B	SS-6121210-SP	Clamp screw	1
19	SS-6661110-SP	Screw	2	52	B-1636-581-000	Needle bearing	1
20	B-1612-161-000	Feed rocker shaft connecting rod	1	53	B-1611-161-000	Feed eccentric thrust washer	1
21	B-1621-555-000	Reverse feed control lever shaft	1	54	SS-2110930-SP	Screw	3
22	B-1627-555-000	Crank	1	55	B-1217-555-0A0	Hand wheel, assembly	1
23A	SS-6121210-SP	Clamp screw	1	56	B-1624-555-000	Reverse feed control lever	1
24A	SS-8150710-SP	Screw	1	57	SS-8660970-TP	Screw (A)	1
25	SS-7110910-SP	Screw, for suspension stud	1	58	SS-8660810-TP	Screw (B)	1
26	SS-7620750-SP	End screw	2	59	WZ-1052010-KP	Washer	1
27	RO-0611801-00	Rubber ring, small	1	60	B-1147-555-000	Feed regulating stop pin	1
28	RO-0691801-00	Rubber ring, large	1	61	B-1148-555-000	Spring	1
29	B-1646-555-000	Tension spring	1	62	B-1618-161-000	Feed driving rocker arm hinge pin	1
30	B-1632-555-000	Suspension bracket	1	24D	SS-7151120-SP	Screw	1
31	SS-7111120-SP	Screw	1	63	B-1615-555-000	Feed driving rocker hinge pin	1
32	B-1649-161-000	Adjusting screw	1	24E	SS-8150710-SP	Screw, for feed driving shaft bushing, rear	1
33	NS-6110420-SP	Nut	2	66	MDB-100B1400	Needle (DB X 1 #14)	1
34	B-1617-555-000	Feed driving rocker	1	64	B-1166-552-000A	Rubber plug for feed driving shaft	1
24C	SS-8150710-SP	Screw (A)	1	67	B-1189-415-000	Rubber plug for feed regulator	1

8 NUMERICAL INDEX OF PARTS

Part No.	Page	Ref. No.	Part No.	Page	Ref. No.	Part No.	Page	Ref. No.	Part No.	Page	Ref. No.	Part No.	Page	Ref. No.
EXCLUSIVE PARTS														
B-1101-552-0A0	1-16		B-1418-543-000	2-57		B-1629-555-000	7-51		B-3501-552-0A0	5-24		NS-6680330-SP	7-46	
B-1101-555-0A0	1-(16)		B-1419-155-000	2-8		B-1630-555-000	7-47		B-3502-122-000	5-29		NS-6680410-SP	4-51	
B-1104-122-000	1-4		B-1419-553-000	2-54		B-1632-555-000	7-30		B-3503-122-000	5-31				
B-1105-122-000	1-5		B-1423-543-000	2-56		B-1633-555-000	7-40		B-3504-155-000	5-32		PIN		
B-1106-122-000	1-44		B-1426-352-800	4-26b		B-1634-555-000B	7-7		B-3507-155-000	5-27		PS-0200122-K0	5-25	
B-1109-012-A00	7-2		B-1501-127-000	3-4		B-1635-552-000	4-22		B-3510-552-000	5-34				
B-1110-012-0A0	1-6		B-1502-541-000	3-9		B-1636-581-000	7-52		B-3511-122-000	5-19		SNAP RING		
B-1111-012-000	1-7		B-1505-227-000A	3-3		B-1646-555-000	7-29		B-3512-122-000	5-18		RE-0500000-K0	3-28	
B-1113-155-0A0	1-21		B-1505-552-000A	3-(3)		B-1648-012-000	7-10		B-3513-352-000	5-14		RE-0500000-KE	4-34	
B-1113-155-000	1-21a		B-1507-552-000	3-5		B-1649-161-000	7-32		B-3513-227-000	5-17		RE-0600000-K0	3-25	
B-1113-155-000	1-15		B-1509-227-000	3-1		B-1701-555-000	7-38		B-3514-552-000	5-15				
B-1117-552-000	2-1		B-1510-227-000	3-58		B-1702-155-000	4-48		B-3514-412-000	5-21		RUBBER RING		
B-1118-522-000	1-17		B-1513-543-8A0	3-(11)		B-1702-552-000	4-24		B-3516-552-000	5-12		RO-0291801-00	2-27	
B-1119-522-000	1-18		B-1515-552-000	3-19		B-1703-155-000	4-52		B-3521-552-0A0	5-22		RO-0442401-00	2-31	
B-1121-552-0A0	1-1		B-1516-552-000	3-22		B-1704-155-000	4-19		B-3524-552-000	5-5		RO-0611801-00	4-53	
B-1122-552-000	1-11		B-1517-552-000	3-23		B-1708-555-000	4-39		B-3527-552-000	5-36		RO-0611801-00	7-27	
B-1123-552-000A	1-23		B-1513-552-000	3-17		B-1709-552-000	4-42		B-3528-552-0A0	5-1		RO-0691801-00	7-28	
B-1126-552-000	1-27		B-1518-552-0A0	3-(15A)		B-1801-412-000	3-40		B-3529-226-000	5-1C		RO-0742401-00	7-6	
B-1126-553-000	1-46		B-1520-552-000	3-13		B-1802-412-0A0	3-4		B-3531-552-000	5-13		RO-2943101-00	2-40	
B-1128-522-000	1-25		B-1520-552-0A0	3-*		B-1803-552-000	3-41		B-3534-155-000	5-8				
B-1147-555-000	7-60		B-1521-552-000	3-7		B-1804-552-800	3-37		B-3536-122-000	5-3		SCREW STUD		
B-1148-555-000	7-61		B-1522-552-000	3-16		B-1806-038-000	3-38		B-3545-122-000	5-30		SD-1020701-SP	4-50	
B-1164-012-000	1-14		B-1523-226-000	3-57		B-1808-552-0A0	3-49		B-3546-541-000	5-2		SD-1020701-SP	7-45	
B-1166-552-000A	1-43		B-1524-012-0A0	3-11		B-1810-552-000	3-48		B-3547-541-000	5-11		SD-0260271-SP	4-38	
B-1166-552-000A	7-64		B-1524-543-8A0	3-56		B-1811-541-000	3-46		B-8217-552-0C0	6-*		SD-0380552-SL	1-21d	
B-1179-552-000	1-3		B-1601-552-000	4-15		B-1830-127-0A0	3-52		B-8217-552-0A0	6-*		SD-0500401-SP	7-48	
B-1186-552-000	1-22		B-1602-155-080	4-3		B-1835-012-000	3-46		B-8218-552-000	6-4		SD-0630275-SP	3-20	
B-1187-552-000	1-20		B-1603-155-000	4-6		B-1837-012-0A0	3-55		B-8219-125-000	6-8		SD-0630301-SP	2-21	
B-1188-552-000	1-12		B-1604-012-000	4-4		B-1901-552-0A0	2-22		B-8226-125-000	6-2		SD-0720331-SP	3-30	
B-1189-415-000	7-67		B-1604-155-000	4-16		B-1903-552-000	2-16		B-8227-125-000	6-1				
B-1201-552-000	2-23		B-1607-155-0A0A	4-43		B-1904-552-000	2-20		B-8228-125-000	6-6		SCREW		
B-1201-555-000	7-3		B-1608-161-000	7-42		B-1905-541-000	2-18		B-9117-012-000	3-54		SM-9061003-SE	6-23	
B-1202-552-800	2-(33)		B-1609-552-000	4-25		B-2611-372-000	5-20		BP-3000000-00	5-11		SQ-1110402-MZ	5-9	
B-1202-552-800A	2-33		B-1609-155-000	4-13		B-3111-552-800	1-32		B-1109-552-000	1-9		SS-3091440-SP	5-16	
B-1203-227-000	2-34		B-1610-155-080	4-43		B-3111-552-0A0	1-*		B-1109-543-000	1-(9)		SS-2110920-TP	1-10	
B-1204-552-800	2-39		B-1610-552-000A	4-26a		B-3114-761-000	1-29		B-1524-552-0A0	3-(11)		SS-2110930-SP	7-54	
B-1206-552-000	2-28		B-1610-552-0A0A	4-26		B-3115-552-000	1-37		B-1509-227-0A0	3-1		SS-4080620-TP	4-1	
B-1206-553-000	2-59		B-1610-553-0A0A	4-(26)		B-3116-125-000	1-42					SS-5060310-SP	2-58	
B-1208-552-000A	2-41		B-1610-555-000	7-18		B-3118-352-000	4-32		OIL WICK			SS-5090610-SP	1-28	
B-1209-552-000	2-19		B-1611-155-000	4-45		B-3118-552-C00	1-35		CQ-2020000-00	1-20		SS-6060210-SP	1-8	
B-1209-553-000	2-60		B-1611-161-000	7-53		B-3120-125-000	1-41		CQ-2020000-00	2-15		SS-6080320-SP	1-(13)	
B-1212-552-A00	2-13		B-1611-552-000A	4-27		B-3126-012-000	1-38		CQ-2020000-00	4-21		SS-6080410-SP	1-13	
B-1213-552-000	2-25		B-1612-161-000	7-20		B-3127-127-000	1-34		CQ-2020000-00	4-21A		SS-6080410-SP	4-14	
B-1214-038-000	5-7		B-1612-552-000A	4-30		B-3128-012-000	1-36		CQ-3030000-00	4-21C		SS-6081010-TP	5-28	
B-1217-552-000	2-42		B-1613-012-A00	7-1		B-3139-012-A00	1-40		CQ-3030000-00	4-21B		SS-6081210-SP	5-33	
B-1217-555-0A0	7-55		B-1613-552-000	4-2		B-3132-552-000	1-39		CQ-3030000-00	4-21D		SS-6090650-SP	3-8	
B-1224-552-000	2-26		B-1613-543-000	4-(2)		B-3148-123-000	1-21b		CQ-3030000-00	4-21E		SS-6090670-TP	2-6	
B-1226-552-000	2-24		B-1613-555-000	7-44		B-3149-123-A00	1-21c					SS-6110560-TP	3-53	
B-1233-012-000	2-44		B-1614-555-000	7-39		B-3411-552-000	3-26		THRUST COLLAR			SS-6111010-SP	3-47	
B-1301-552-000	2-45		B-1615-552-000	4-29		B-3413-227-000	3-32		CS-0640863-SH	4-11		SS-6121050-SP	7-9	
B-1302-552-800	2-46		B-1615-553-000	4-29x		B-3414-552-000	3-29		CS-0791016-SH	2-47		SS-6121210-SP	5-(26b)	
B-1303-552-800	2-49		B-1615-555-000	7-63		B-3415-552-000	3-35		CS-0791016-SH	3-42		SS-6121210-SP	7-23A	
B-1305-012-000	2-36		B-1617-555-000	7-34		B-3416-012-000	3-33		CS-0791066-SH	3-50		SS-6121210-SP	7-23B	
B-1306-155-000	2-*		B-1618-161-000A	7-62		B-3416-552-000	3-27		CS-1471212-SH	7-16		SS-6121610-SP	4-40A	
B-1307-155-000	2-50		B-1618-552-0A0	4-31		B-3417-552-000	3-31		CS-1471212-SH	4-46		SS-6121610-TP	4-40B	
B-1308-155-0A0	2-51		B-1619-155-000	4-36		B-3418-552-000	3-34					SS-6121610-TP	7-43	
B-1401-552-A00	2-4A		B-1619-555-000	7-36		B-3419-122-000	6-21		NEEDLE			SS-6661110-SP	7-19	
B-1401-552-B00	2-4B		B-1620-155-000	4-41		B-3419-552-0A0	6-*		MDB-100B1400	7-66		SS-6741010-SP	6-7	
B-1401-552-C00	2-4C		B-1620-161-000	7-5		B-3420-552-000	6-9		MDB-257B1400	2-10		SS-7080510-SP	2-11	
B-1401-552-D00	2-4D		B-1621-555-000	7-21		B-3420-552-0A0	6-*		MDB-257B1800	2-(10)		SS-7091110-SP	3-12	
B-1401-553-A00	2-52		B-1621-552-000	4-33		B-3421-552-0A0	6-5					SS-7110510-SP	1-24	
B-1402-552-000A	2-2		B-1622-555-000	7-13		B-3424-552-000	6-15		NUT			SS-7110540-SP	4-23	
B-1403-155-000	2-7		B-1623-552-000	4-35		B-3425-552-000	6-14		NS-2820850-SA	3-2		SS-7110710-SP	4-12B	
B-1453-553-000	2-53		B-1623-555-0A0A	7-8		B-3427-552-000	6-13		NS-6060350-SP	1-30		SS-7110710-SP	5-4	
B-1408-552-000	2-14		B-1624-552-000	4-37		B-3427-122-000	6-10		NS-6110420-SP	7-33		SS-7110720-SP	7-4	
B-1411-552-0A0	2-5		B-1624-555-000	7-56		B-3429-552-000	6-20		NS-6120310-SP	7-50		SS-7110910-SP	1-19	
B-1414-232-000	2-12		B-1625-555-000	7-12		B-3430-552-000	6-28		NS-6150310-SP	1-45		SS-7110910-SP	5-6	
B-1416-543-0A0	2-55		B-1626-555-000	7-15		B-3431-552-000	6-22		NS-6150430-SR	6-19		SS-7110910-SP	7-25	
B-1418-541-A00A	2-9		B-1627-555-000	7-22		B-3431-581-000	3-24		NS-6150430-SR	6-12		SS-7111120-SP	4-20	
			B-1628-555-000	7-11		B-3432-552-000	6-27		NS-6620310-SP	3-36		SS-7111120-SP	1-2	

Part No.	Page	Ref. No.
SS-7111120-SP	7-31	
SS-7111120-SP	7-37A	
SS-7111260-SP	7-41	
SS-7111310-TP	4- 7	
SS-7111410-SP	3- 6	
SS-7111410-SP	4-44	
SS-7121410-SP	5-(26)	
SS-7121410-SP	5-26	
SS-7120910-SP	3-14	
SS-7151120-SP	2-35	
SS-7151120-SP	7-24D	
SS-7620750-SP	7-26	
SS-7681750-TP	2-30	
SS-8090670-SP	1-31	
SS-8110410-TP	3-51	
SS-8110510-SP	1-26	
SS-8110510-SP	7-65	
SS-8110510-SP	4-12A	
SS-8110520-TP	2-48	
SS-8110520-TP	3-43	
SS-8150310-SP	2- 3	
SS-8150310-SP	3-10	
SS-8150410-SP	4-49	
SS-8150710-SP	1-33	
SS-8150710-SP	4-17A	
SS-8150710-SP	4-17B	
SS-8150710-SP	4-18B	
SS-8150710-SP	7-24A	
SS-8150710-SP	7-24B	
SS-8150710-SP	7-24C	
SS-8150710-SP	7-24E	
SS-8150710-TP	7-14	
SS-8151150-SP	2-21A	
SS-8151150-SP	2-21B	
SS-8151150-SP	2-21C	
SS-8151150-SP	3-45	
SS-8151230-SP	7-14	
SS-8151550-SP	2-43	
SS-8151550-SP	3-39	
SS-8151550-SP	4-18A	
SS-8152080-SR	1-17	
SS-8153010-SR	6-18	
SS-8182010-SN	6-24	
SS-8620610-SP	7-35	
SS-8620610-TP	4- 5	
SS-8660410-TP	7-57	
SS-8660610-TP	2-32	
SS-8660610-TP	4-47	
SS-8660610-TP	7-17	
SS-8660810-TP	7-58	
SS-8660810-TP	2-38	
SS-8661430-SP	4-28	
SS-8681950-SP	2-62	
SS-9151120-SR	6-16	
SS-9151540-SR	6-11	
SS-9661120-CP	2-29	

WASHER

WP-0550800-SP	5-38
WP-0740516-SP	3-61
WZ-0541510-KP	7-49
WZ-1052010-KP	7-59