

STRUCTURE DIAGRAM

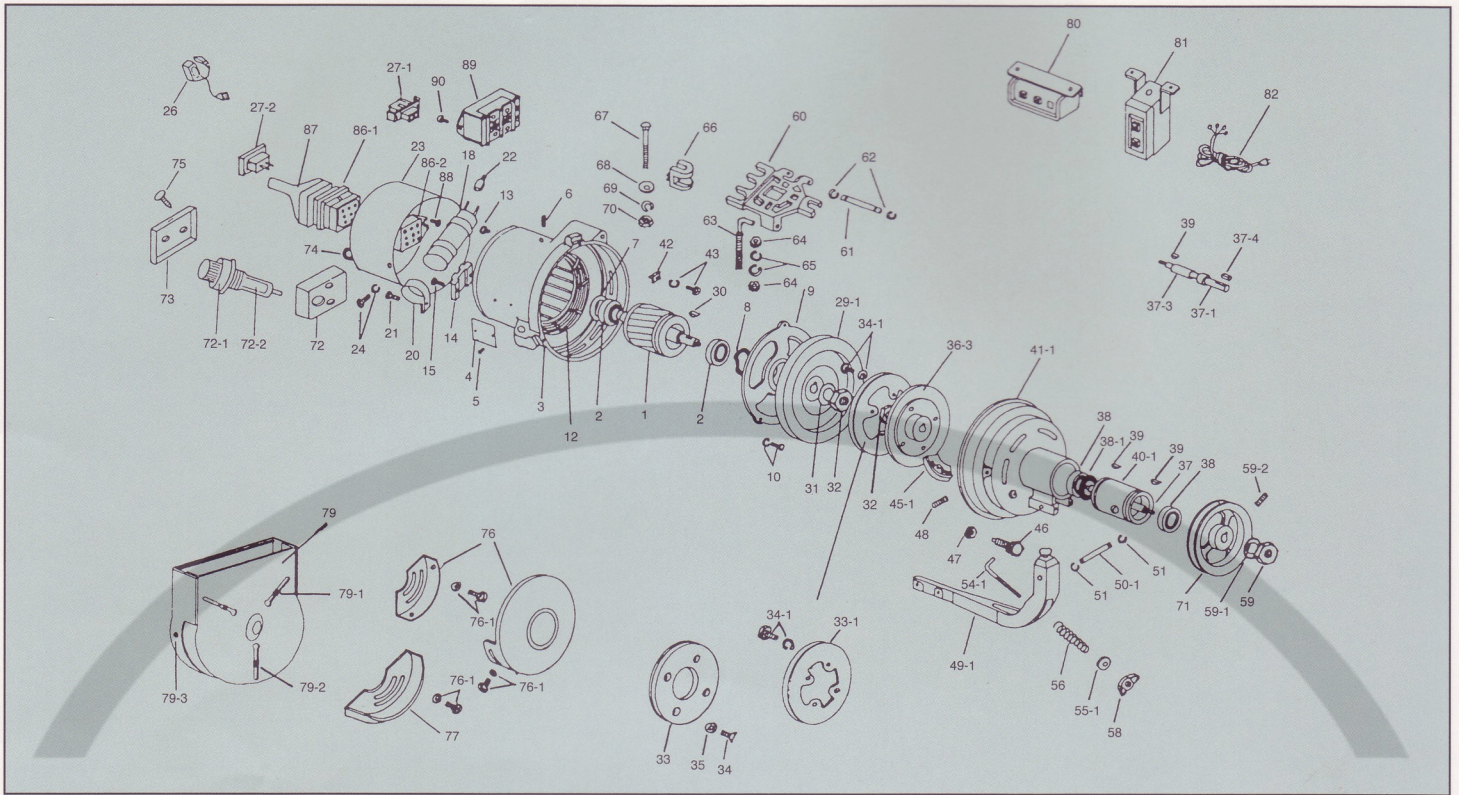

SUFFIX NOMINATION

SUFFIX	PLEASE SPECIFY (A/B/C/D/E) YOU NEED AS BELOW
A	1/8 HP
B	1/4 HP, 1/3 HP, 2/5 HP
C	1/2 HP, 2/3 HP for Three phase or Single phase 2 poles.
D	1/2 HP for Single phase 4 poles, 0.6 HP and 1 HP for Three phase or Single phase 2 poles.
E	1.5 HP and 1 HP for Single phase 4 poles

PARTS LIST

Ref.NO.	Name of Parts	Q'ty	Special Comments	Ref.NO.	Name of Parts	Q'ty	Special Comments	Ref.NO.	Name of Parts	Q'ty	Special Comments
1	Rotor	1	* 1	33-1	Clutch lining	1		65	Spring washer for No.63	2	
2A	Ball bearing #(6202)	2		34	Set screw for No.33	4		66	Vibration absorbing rubber	3	
2-B,C,D,E	Ball bearing #(6203)	2		34-1	Set screw for No.33-1	4		67	Motor mounting bolt	3	May order complete set bt: parts No. CS67
3A	Frame	1	* 1	35	Stop washer for No.33	4		68	Plain washer for No.67	3	
3B	Frame	1	* 1	36-3	Clutch plate	1		69	Spring washer for No.67	3	
3C	Frame	1	* 1	37	Clutch shaft	1		70	Nut for No.67	3	
3D	Frame	1	* 1	37-1	Clutch shaft	1	For AMCO Pulley	71	Pulley	1	PLS INDICATE "SIZE"
3E	Frame	1	* 1	37-3	Clutch shaft sleeve	1			72	Box for terminal board	1
4	Medallion	1		37-4	Key for No.37-1	1		72-1	Fuse holder	1	
5	Revit	2/4		38	Ball bearing #(6202)	2		72-2	Fuse	1	
6	Set screw for No.12	1		39	Woodfull key for No.37,37-1	2		73	Cover	1	
7-A	Neoprine thrust washer	1		40-1	Clutch adjusting sleeve	1		74	Bushing	1	
7-B,C,D,E	Neoprine thrust washer	1		41-1A	Pulley side end bracket	1		75	Set screw for No.72	2	
8A	Wave washer	1		41-1.B,C,D	Pulley side end bracket	1		76	Belt cover (FULL ENCLOSED)	1	May order complete, set by parts No.CS76 or CS 77
8-B,C,D,E	Wave washer	1		41-1-E	Pulley side end bracket	1		76-1	Set screw for No.76,77	2/4	
9-A	Center bracket	1		42	Clutch end cover retainer	3		77	Belt cover (HALF)	1	
9-B,C,D,E	Center bracket	1		43	Set screw for No.41-1	3		79	Safety belt cover	1	
9-E	Center bracket	3		45-1	Brake shoe	1		79-1	Finger guard	2	For CE approval
10	Set screw for No.9	1		46	Brake adjusting screw	1		79-2	Belt drop preventer	1	May order complete by P/N. CS79
12	Stator	1		47	Nut for No.46	1		79-3	Set screw for No.79	3	
13	Set screw for earth	1		48-A	Set screw for No.45-1	1		80	Push button switch only	1	*2
14	Terminal board	1	Specify single or three phase	48-B,C,D,E	Set screw for No.45-1	1		CS80	Push button switch and wire	1	*2 complete
15	Set screw for No.14	2			49-1	Clutch lever	1		81	Safety switch only	1
18	Capacitor	1	* 2	50-1	Lever pin	1		CS81	Safety switch and wire	1	*2
20	Capacitor band	1	* 2	51	Stop ring for No.50-1	2		82	Power cord with earth wire	1	*2
21	Set screw for No.20	1		54-1	Lever adjusting screw	1	May order complete set by parts NomCS54	86-1	Reversing plug (male)	1	OPTION
22	Terminal sleeve	2		55-1	Washer for No.54-1	1			86-2	Reversing plug (female)	1
23A	End cover	1		56	Spring for No.54-1	1		87	Cap for No.86-1	1	OPTION
23-B,C,D	End cover	1		58	Wing nut for No.54-1	1		88	Set screw for No.86-2	2	OPTION
23-E	End cover	1		59	Pulley lock nut	1		89	110/220V change switch	1	OPTION
24	Set screw for No.23	2		59-1	Spring washer for No.59	1		90	Set screw for No.89	2	OPTION
26	Heyco bushing	1		59-2	Set screw for pulley	1	For AMCO ONLY				
27-1	Receptacle for light	1	Molex 1545P	60A	Slide base	1					
27-2	Receptacle for light	1	Molex 1545P	60-B,C,D	Slide base	1					
29-1	Fly wheel	1	* 1	60E	Slide base	1					
30	Woodruff key for No.29-1	1		61	Base pin	1					
31	Washer for No.29-1,36-3	2		62	Stop ring for No.61	2					
32	Hexagonal nut for No.29-1,36-3	2		63	Belt adjusting bolt	1					
33	Clutch lining	1		64	Nut for No.63	2					

NO SUFFIX : COMMON PARTS

*1 : PLEASE SPECIFY THE SERIAL NUMBER

*2 : PLEASE SPECIFY THE HP, PHASE, VOLT, CYCLES AND RPM